

GENERAL NOTE:
Cargo tanks are protected with a suitable coating according to IBC.

CLASS NOTATION
BV I + HULL OIL/CHEMICAL IMO II TANKER-ESP UNRESTRICTED NAVIGATION AUT-UMS,CLEAN SHIP,AVM-DPS,VC3-TRANSFER INWATERSURVEY

NOTE : Air pipe height of ballast tanks are 760 mm. above the highest point of considered.
Liquid cargo max=1.35t/m Pv=0.21bar
Allowed partial loading at sounding depth 5.00mt. is =1.54t/m
Alternative / Asimetrical cargo loading at sea
Steel : Grade A
Remin : 235 MPa
Cargo heating max. temperature 90 C
Minimum forward draught is 1.8 m

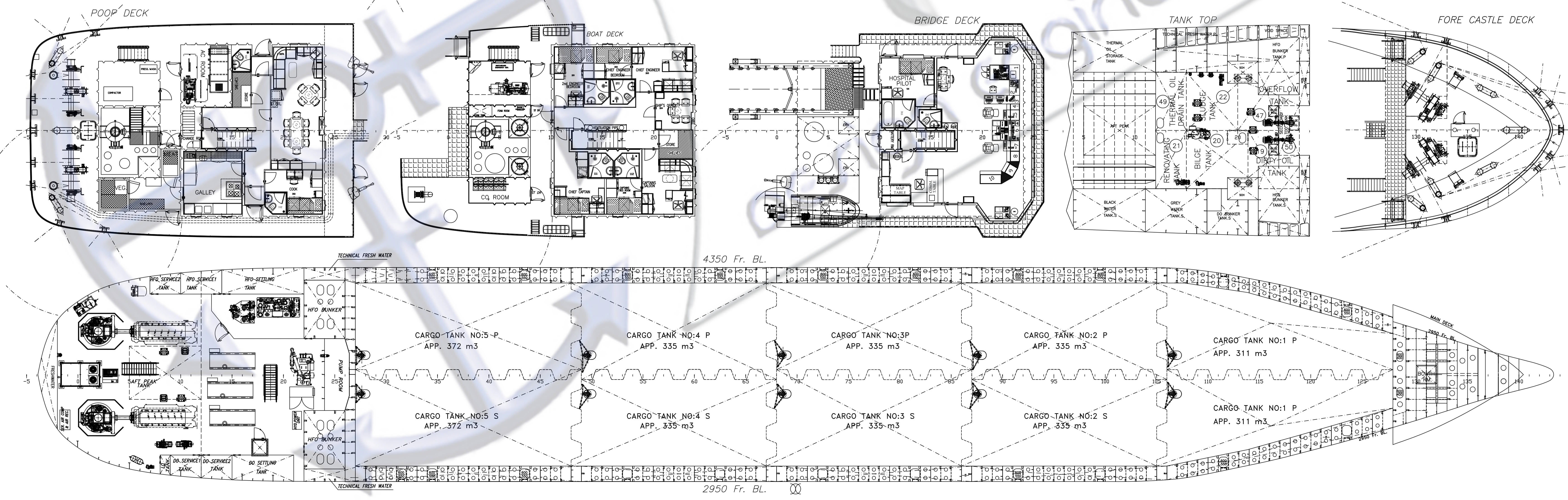

MAIN DIMENSIONS :

LENGTH OVERALL : 89.71 m.

LENGTH B.P. : 83.30 m.

BREADTH : 12.50 m.

DEPTH : 6.10 m.

DRAUGHT(Design) : 5.13 m.

DESIGN DWT. : 3150 DWT.

DRAUGHT(Scantling) :

CARGO CAPACITY AT %100 Abt. 3410 m³(EXCL. SLOP)

REV. NO	DATE	REVISION NOTE
26	04/01/10	SHIP'S DATAS REVISED
25	13/08/08	SHIP'S DATAS REVISED
24	01/11/08	SHIP'S DATAS REVISED
23	09/06/08	MAIN DECK PROFILE LINE CORRECTED.
22	04/06/08	SEP. SLUDGE TANK ADDED.
21	28/05/08	ACCOM. ARRANGEMET AS BUILT
20	17/04/08	MOORING ARRANGEMENT & AFT MAST AS BUILT.
19	08/04/08	TRIM TANK ARRANGEMENT CHANGED.
18	18/01/08	PROFILE VIEW OF HATCH ADDED (FORE CASTLE DECK)
17	05/09/07	OWNER'S REMARKS ADDED.
16	05/09/07	OWNER'S REMARKS ADDED.
15	03/09/07	OWNER'S REMARKS ADDED.

THIS DESIGN AND ITS COPYRIGHTS ARE PROPERTIES OF "TEOMAN TOMBAK / TOMAY". THE DRAWINGS & SPECIFICATIONS CONTAINED HEREIN SHALL NOT BE REPRODUCED IN WHOLE OR IN PART, OR NOT TO BE GIVEN TO THIRD PARTIES WITHOUT WRITTEN PERMISSION FROM "TEOMAN TOMBAK / TOMAY".
BU DİZAYN VE BUNUNLA İLGİLİ REZİMLERİN TELİF HAKLARI "TEOMAN TOMBAK" A AİTTİR. "TEOMAN TOMBAK" NIN YAZILI İZİNİNSİZ OLARAK BU DOKÜMAN VEYA BUNUN BİR KOPYA USULÜNÜ SAHİPLERİNE VERİLMEMİZ, TEKİR VEYA KOPYA EDİLMEMİZ VE HER NE MAKSATLA OLURSA OLUSUN MAKSADINI DİŞİNDE KULLANILMAMAZ.

TOMAY
DESIGN CONSULTANT
CONSTRUCTION OUTFITTING
REPAIRING THICKNESS MEASUREMENT

3165 D.W.T.
CHEMICAL/OIL PRODUCT
TANKER

M/T DÜZGİT VENTURE
GENERAL ARRANGEMENT

DESIGNED BY	TEOMAN TOMBAK	CLASS	
CAD OPT.	TEOMAN TOMBAK		B.V. (10060M)
CONTROL	ALI DÜZGİT		HULL NO
APPROVED BY	-		NB-11
SHIP YARD	SELAHATTIN ASLAN	PROJECT NO	CPT-09
		DRAWING NO	R-01
OWNER	DÜZGİT GEMİ İNŞA SANAYİ A.Ş.	SCALE	1/100
		DATE	26/06/2006